

the greenlaw works.

Flexible new workspace in Newton Mearns.

6 Greenlaw Way | Newton Mearns | East Renfrewshire | G77 6EF

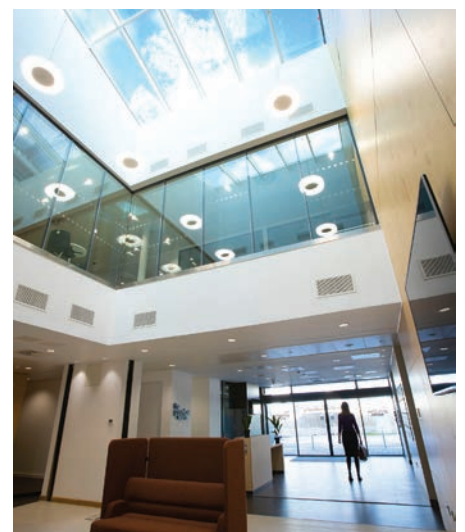

Viewings by appointment:
thegreenlawworks@eastrenfrewshire.gov.uk
eastrenfrewshire.gov.uk/thegreenlawworks



Dedicated office suites.

Private offices for small businesses ranging from 162 sq ft to 664 sq ft (approx 2-10 people) with flexible access hours. Inclusive of phone line, mailbox and IT package. Fully furnished options available.

Co-working lounge.

Perfect for start-ups, sole traders and freelancers. A dedicated desk within the co-working lounge offers a professional environment for individual working or collaboration.

Meeting rooms and breakout areas.

From informal meetings, to workshops and seminars – there is a range of breakout areas and bookable meeting rooms equipped with presentation and video conferencing facilities.

Key features:

- 93 car parking spaces
- Superfast commercial broadband
- All inclusive package
- Flexible licence/lease terms
- Mailboxes and lockers
- Cycle racks and shower facilities
- Electric Vehicle charging points

Location.

A range of shops, restaurants and a hotel are available within Greenlaw Village, directly accessible from Junction 4 of the M77.



Patterson Park and Ride
12 mins walk



Glasgow City Centre
15 mins drive



Glasgow Airport
20 mins drive

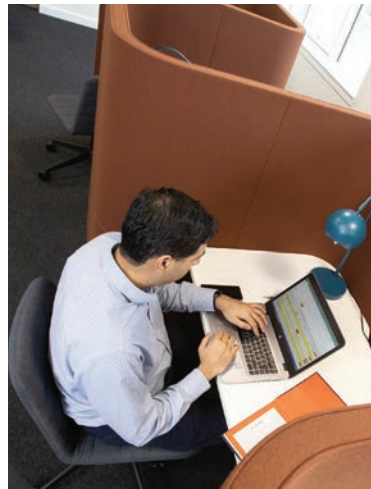

Rateable Value/VAT. The tenant will be responsible for any rates payable. Tenants may be eligible for Rates Relief under the Small Business Bonus Scheme. The property is not liable for Value Added Tax (VAT).

No warranty or representation, express or implied, is made to the accuracy or completeness of the information contained herein and same is submitted subject to errors, omissions, change of specification, price, rental or other conditions, withdrawal without notice, and all agreements are subject to formal written approval of East Renfrewshire Council. Maps reproduced by permission of Ordnance Survey on behalf of HMSO. © Crown Copyright and database right 2020. All Right Reserved. Ordnance Survey Licence Number 100023382 2020, East Renfrewshire Council.

Date of publication: February 2020