

Drop Kerb Application 2023/24

Before filling out this application please read over the specification and conditions

- The public road is considered to be the carriageway, footway, footpath and verge. If your works are not within an area maintained by the roads department you should contact the roads manager for that area for example a factor .
- You can check if you road is adopted via this link <https://www.eastrenfrewshire.gov.uk/east-renfrewshire-roads>

Driveway layout

- All driveways should be at least 5 metres in length. However, where the driveway abuts a garage, it must be an absolute minimum of 6 metres in length to allow the garage doors to open and retain suitable access to/ from the parked vehicle.
- Any vehicle parked within the driveway must not encroach on the footway or carriageway.
- Steep gradients, which render the proposed driveways unsuitable for car parking, are not recommended (desirable maximum gradients should not exceed 10%). Notwithstanding, consideration should be taken to ensure the vertical profile of the driveway as it meets the public footway/carriageway does not also result in vehicles grounding etc.
- If it is the applicant's intention to install gates at the proposed entrance they must operate inwards or if opening outwards, the gates must be set back from the edge of the public footway or carriageway so that their operation will not interfere with movements on the adjacent footway or carriageway at any time.
- The driveway must be accessed at an angle of 90 degrees
- Where the proposed driveway fronts a main road (generally classified (A & B) and other routes where the speed limit is greater than 30mph), it is preferable that on the grounds of road safety that suitable turning facilities are provided within any proposed driveway to allow all vehicles to enter and exit in a forward gear.
- The heel of the footway MUST be supported, as shown in enclosed details, and the footway will be resurfaced as part of the works.
- A hard surface shall be formed over the first 2 metres of the access to prevent loose materials being deposited on the road.
- Where a new driveway is being formed, surface water must not discharge to the road from the property.

Visibility Splays

- Clear sight-lines from any new access/ driveway are essential to enable drivers to check in both directions for both vehicular and pedestrian traffic before safely adjoin the adjacent public road.
- For the sight lines for vehicular traffic there should be an unrestricted view, above a height of 1.05metres from a point “x” meters back from the carriageway for a distance of “y” metres in both directions.
- On non-classified residential roads (speed limit ≤ 30 mph), a minimum visibility splay of 2.0 metres (x) x 20 metres (y) should preferably be achieved between individual driveways and the adjacent carriageway. Any existing or proposed buildings, structures, fencing, landscaping features (soft or hard), trees, vegetation, etc., within the visibility splay should be and thereafter maintained in perpetuity(where applicable), at a height of not more than 1.05 metres.
- On classified (A & B) and other routes where the speed limit is greater than 30mph and in the interest of road safety, the required visibility splays is likely to more onerous and will be determined on a case-by-case basis. The (x) distance will increase to 2.5metres and the (y) distance may increase up to 90m where the speed limit is 30mph; 120m where the speed limit is 40mph and 160m where the speed limit is 50mph.
- In addition to the above requirements , to ensure an adequate and safe inter-visibility between vehicles exiting from a driveway and pedestrians on any adjacent footway or carriageway, a visibility splay of 2 metres back from the edge of the driveway (‘x’ distance) and 5 metres in either direction from the edge of the driveway (‘y’ distance) should also be provided. No obstructions above a height of 1.05 metres will be accepted in either direction within the aforementioned splay.

What to include in your application

- Your application should include at least one photo of the proposed location and plan of the proposed layout.
- If any sign poles, barrier, road markings or other street furniture needs to be relocated or removed, this should be included in your submission and any costs would have to be paid by the applicant. The Roads Service will carry out all street lighting relocation work and all costs recharged to the applicant. However, it should be noted that It may not be possible to relocate a lighting column as this may result in an insufficient spread of light to British Standards EN13201.
- If any lighting columns, sign poles, barrier,road markings or other street furniture cannot be relocated or removed then the application may be refused or the proposed dropped kerb proposal may require amending.
- The Applicant must arrange for any protection, alteration or deviation to service cables, pipes, inspection chambers etc. necessitated by this alteration. Where this is required the utility provider should be informed.
- If your application is approved you will have to appoint a contractor to carry out the works. Your contractor should be on The Street Works Qualification Register, hold Public Liability Insurance for £5,000,000 and complete a Road Opening Permit application before any of the works are carried out. Evidence of the above will need to be included as part of the Road Opening Permit application submitted by the contractor. The Road Opening Permit will be provided once your application has been approved. The cost of a Road Opening Permit is £159.48 per week or part of. We will expect the works are completed in a reasonable time and permits will only be issued for 1 week. The permit is not required for works within your property and should not be included the time-scales.

We will aim to respond to your application within 8 weeks.

Please complete all the fields in red and submit your application to

roads@eastrenfrewshire.gov.uk.

Prior to any works being carried out in relation to this request, all necessary consents and approvals, particularly Planning and Building Control permission, where appropriate, MUST be obtained by the applicant.

Applicant Information

Name

Address

Locality

Post Code

Contact Number

Email Address

Location of Drop Kerb

As Above

If "No" please fill out the fields below

Address

Locality

Post Code

Additional Information

I hereby make application to East Renfrewshire Council for approval of a drop kerb. I have read and agree to the conditions, specifications and GDPR statement contained with this application

I can confirm that my application meets the requirements and specification

Signed

Date

Data Protection Act 2018

The information you supply on this form will be used by East Renfrewshire Council to process your application.

If you do not provide us with the information we have asked for then we will not be able to provide this service to you.

You can find out more about how we handle this information and your rights in respect of it by viewing our privacy policy <http://www.eastrenfrewshire.gov.uk/privacy>

You can find out how we handle and why we require this information by viewing our Roads and Transportation Privacy Notice <https://www.eastrenfrewshire.gov.uk/roads-privacy-notice>

If you do not have access to a computer and wish a paper copy please let us know by contacting us by telephone at 0141 577 3001.

Construction Details

Section 4 Specific Construction Details

Detail 8a Typical Footway Crossover (for dropped kerb application)

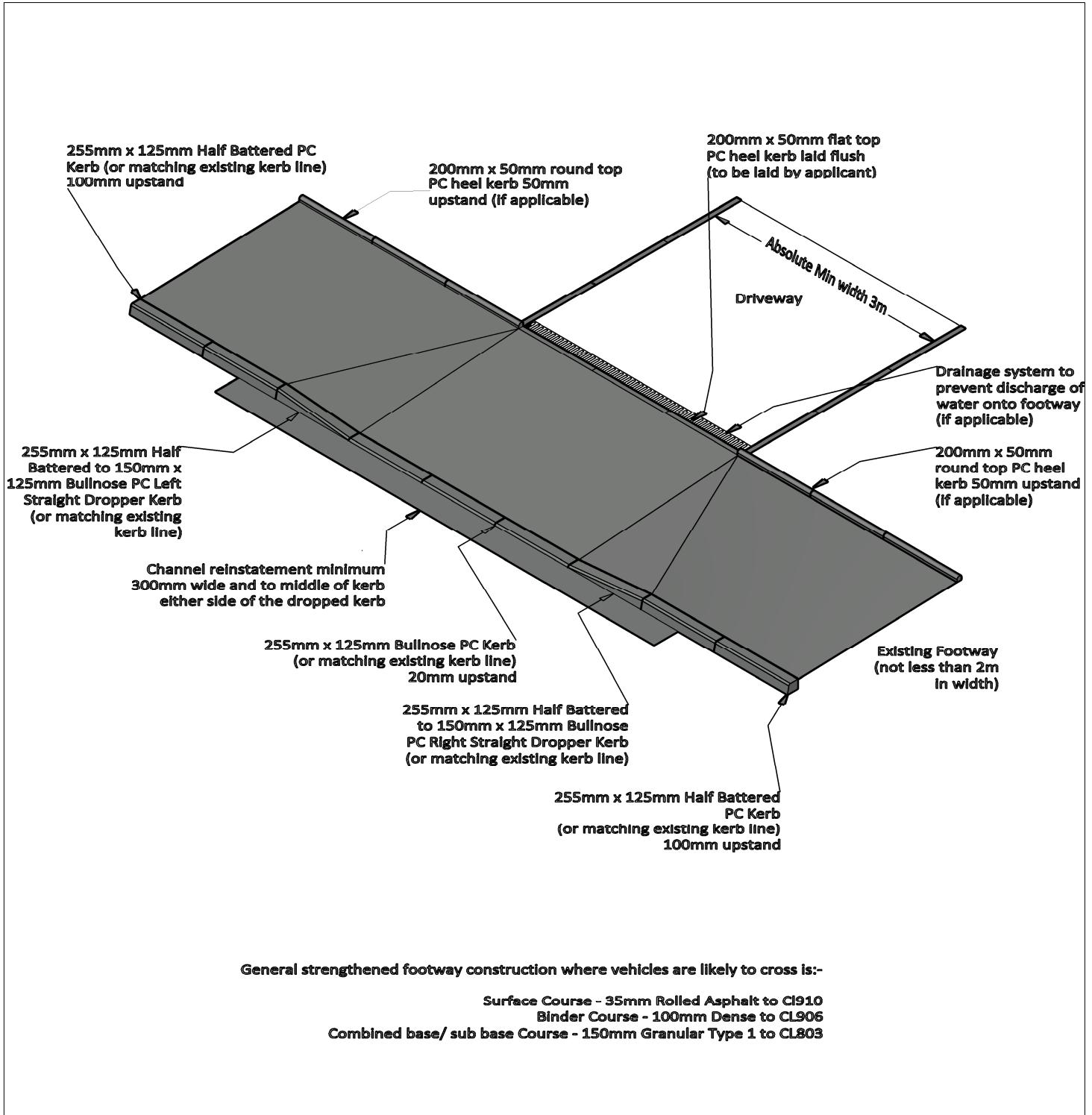

| | |
|----------------------|----------------|
| Drawing No. | CD-S4-D8a |
| Scale | NTS |
| Date | 19 August 2021 |
| Revision | -- |
| Revision Note | -- |

Construction Details

Section 4 Specific Construction Details

Detail 9a Typical Footway/ Verge Crossover (dropped kerb application)

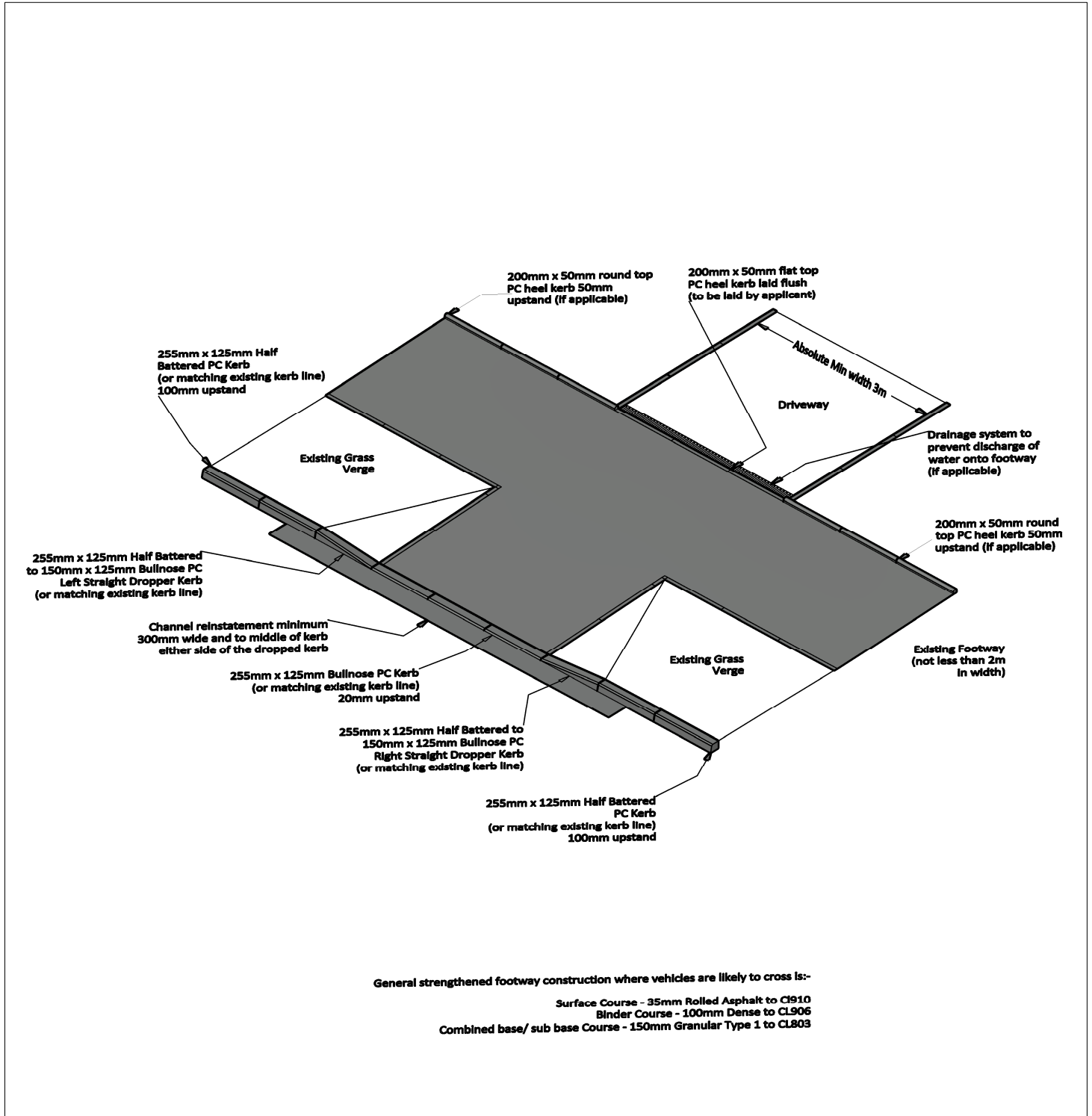

| | |
|----------------------|----------------|
| Drawing No. | CD-S4-D9a |
| Scale | NTS |
| Date | 20 August 2021 |
| Revision | -- |
| Revision Note | -- |

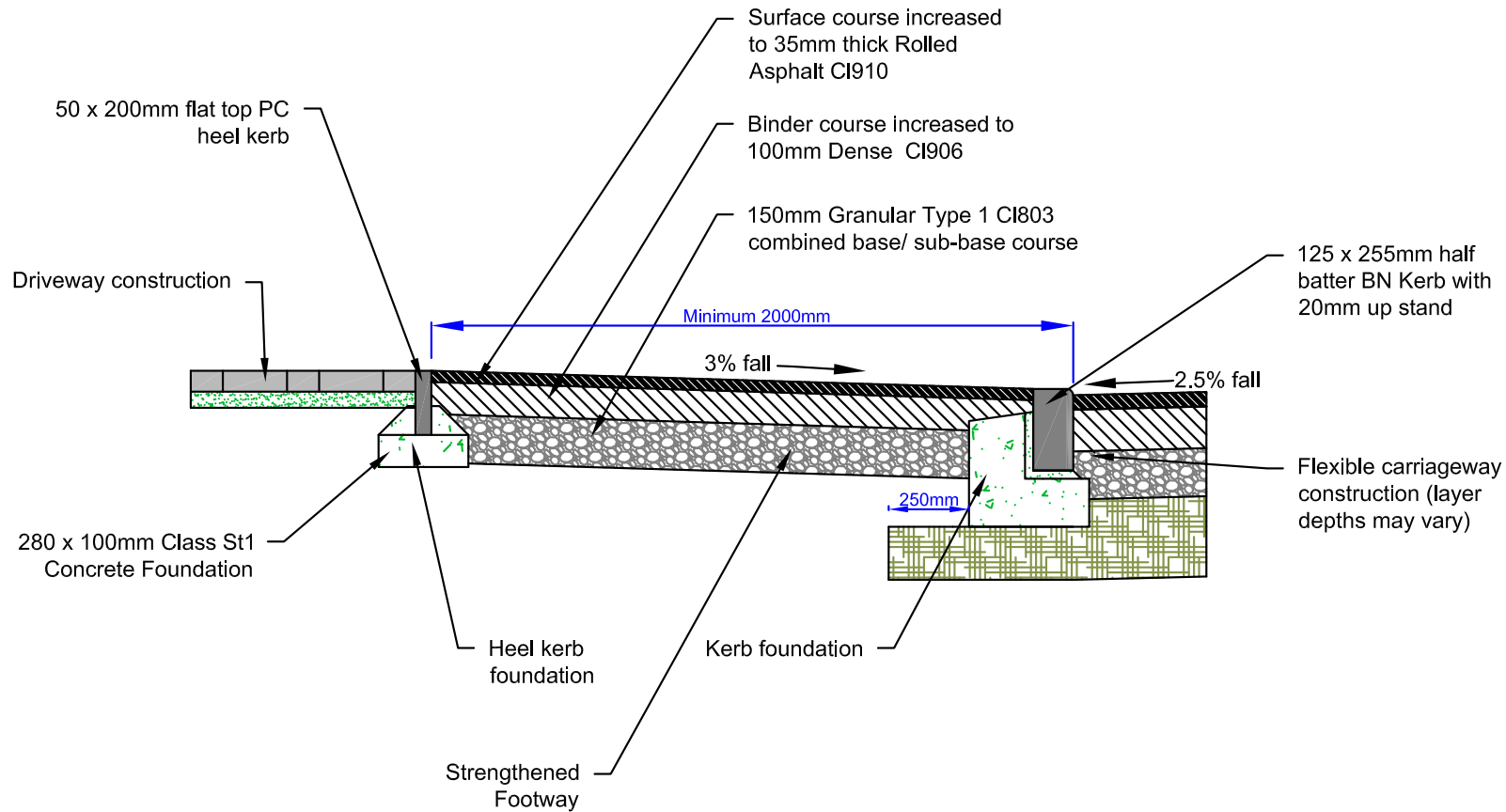

Notes

- Refer to Drawing No. CD-S2-D1 for flexible road construction for housing roads
- Refer to Drawing No. CD-S1-D1 for 125 x 255mm Half Batter Precast Concrete Kerb Detail
- Refer to Drawing No. CD-S1-D5 for 50 x 200mm Precast Concrete Heel/ Edge Kerb Detail

Footway (flexible)
construction where over run
by vehicular traffic

| | |
|---------------|--|
| Drawing No. | CD-S3-D4 (Strengthened footway construction) |
| Scale | 1:25 |
| Date | 28 September 2018 |
| Revision | A |
| Revision Note | A Minor correction to heel kerb arrangement 19/11/19 |

Construction Details

Section 3 Construction Cross Sections

Detail 4 Strengthened Footway (Vehicular Crossing)

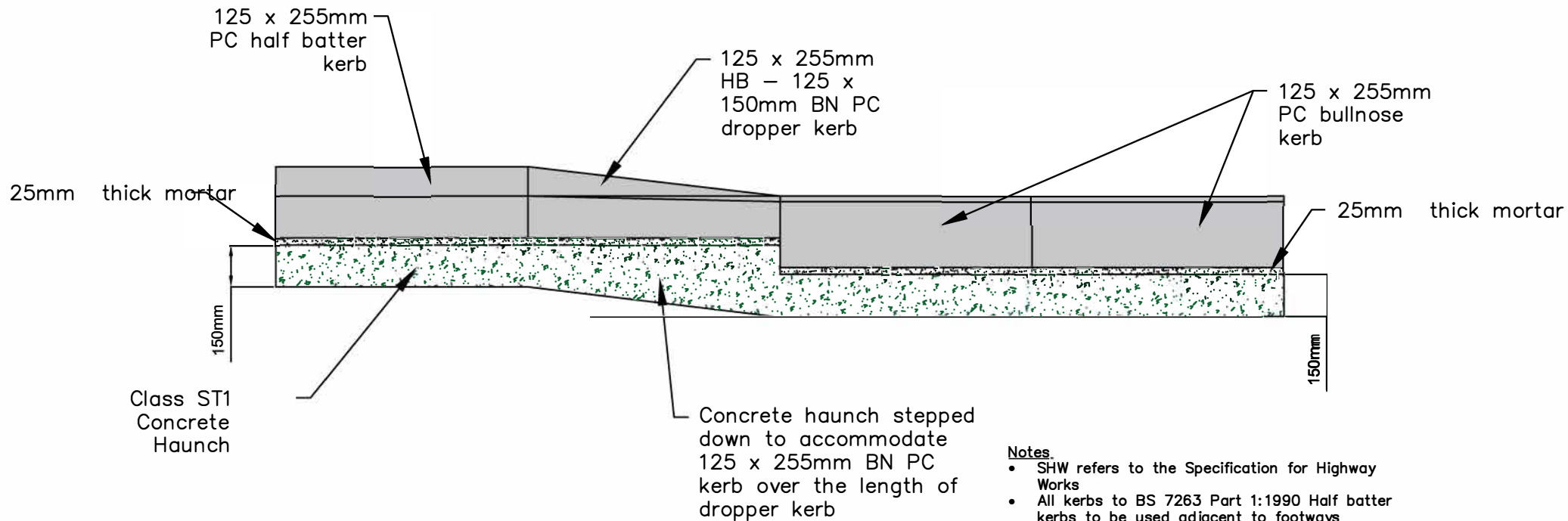

Notes

- SHW refers to the Specification for Highway Works
- All kerbs to BS 7263 Part 1:1990 Half batter kerbs to be used adjacent to footways
- Concrete mix ST1 (SHW Table 26/1: refer BS.5328:Part 2) for bedding and backing to precast concrete kerbs, channels, edgings and quadrants
- All Mortar shall be designation (i) Table 24/1 (SHW)
- Depth of foundation to be 150mm or depth to top of sub base whichever is greater.

Drawing Info.

Reproduced from the Ordnance Survey Mapping with the permission of Her Majesty's Stationary Office (C) Crown Copyright.
 Unauthorised reproduction infringes Crown Copyright and may lead to prosecution or civil proceedings. ERC Licence No. (c) Crown Copyright. 100023382 2015

East Renfrewshire Council - Environment Department
 Environment Service and Roads - 2 Spiersbridge Way, Spiersbridge Business Park,
 Thornliebank, G46 8NG
 Head of Service: Andrew Corry

| | | |
|--|----------|-------------------|
| Drawing Title | | Date |
| Longitudinal kerb log detail at vehicular crossing point | | Scale |
| D | N | Dwg By |
| | | Checked By |
| Revision | | |
| | | |



Construction Details

Section 1 Kerbing

Detail 1 125 x 255mm PC Half Batter Kerb

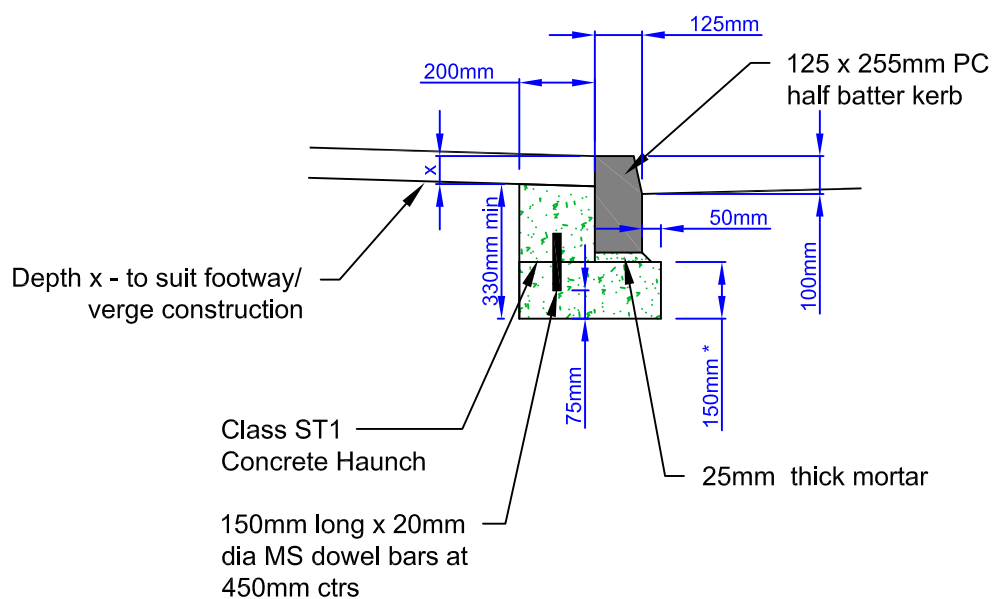
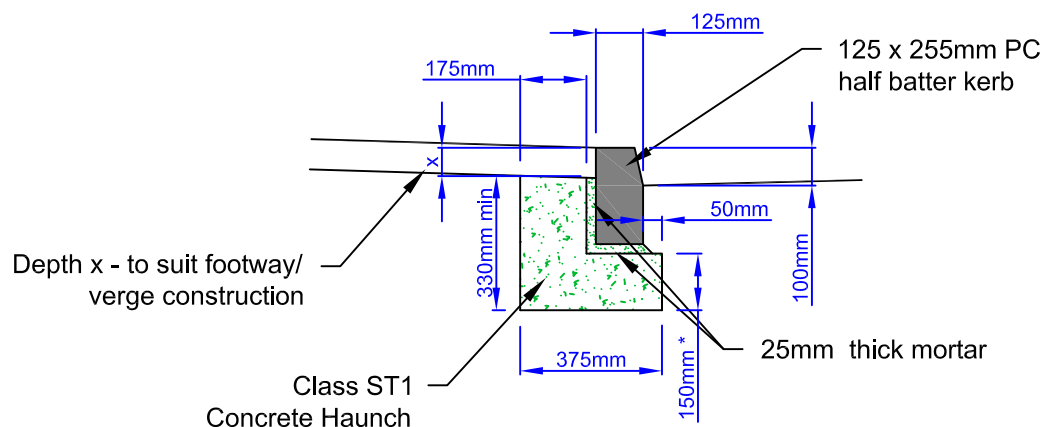

Notes

- SHW refers to the Specification for Highway Works
- All kerbs to BS 7263 Part 1:1990 Half batter kerbs to be used adjacent to footways
- Concrete mix ST1 (SHW Table 26/1: refer BS.5328:Part 2) for bedding and backing to precast concrete kerbs, channels, edgings and quadrants
- All Mortar shall be designation (i) Table 24/1 (SHW)
- Depth of foundation to be 150mm or depth to top of sub base whichever is greater.

125 x 255mm Precast Concrete Half Batter Kerb Detail

| | |
|-----------------|------------------------------|
| Drawing No. | CD-S1-D1 (125 x 255 HB Kerb) |
| Scale | 1:20 |
| Date | 31 August 2018 |
| Revision | A |
| Revision Note A | -Foundation altered 10-10-18 |

Construction Details

Section 1 Kerbing

Detail 2 125 x 255mm PC Bullnose Kerb

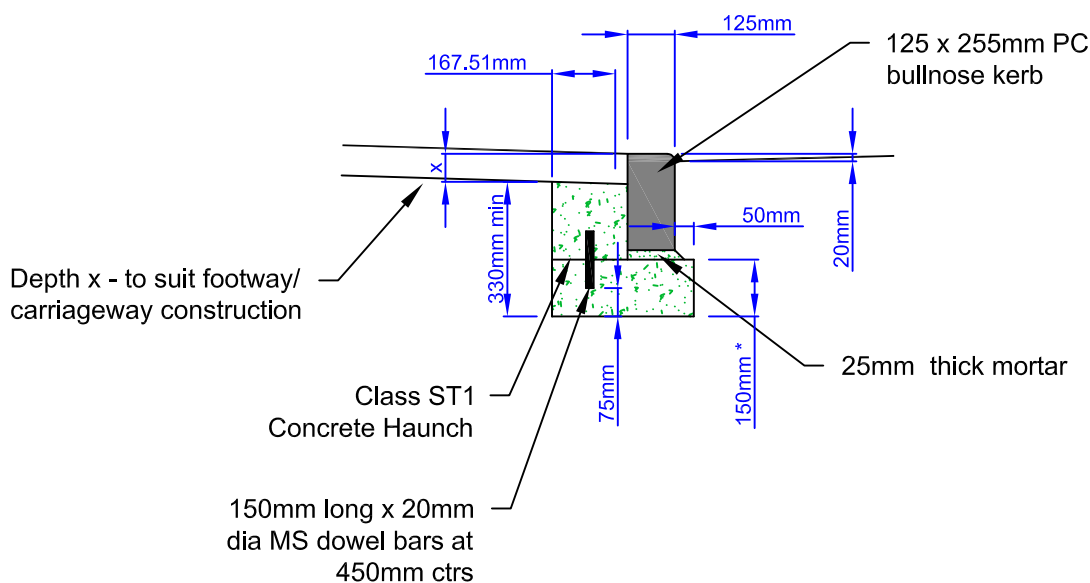
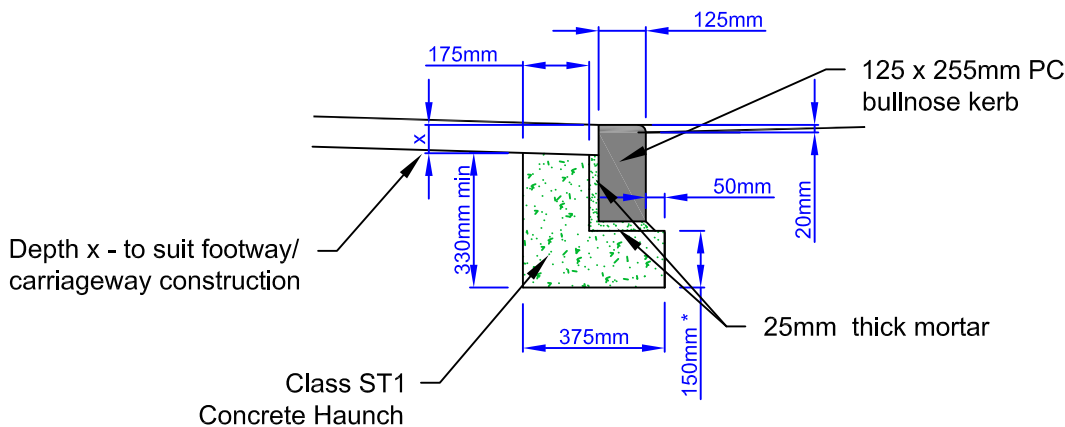

Notes

- SHW refers to the Specification for Highway Works
- All kerbs to BS 7263 Part 1:1990 20mm upstand to face drivers entering into private access.
- Concrete mix ST1 (SHW Table 26/1; refer BS.5328:Part 2) for bedding and backing to precast concrete kerbs, channels, edgings and quadrants
- All Mortar shall be designation (i) Table 24/1 (SHW)
- Depth of foundation to be 150mm or depth to top of sub base whichever is greater.
- For use at all vehicular crossing points

125 x 255mm Precast Concrete Bullnose Kerb Detail

| | |
|---------------|------------------------------------|
| Drawing No. | CD-S1-D2 (125 x 255 BN Kerb) |
| Scale | 1:20 |
| Date | 31 August 2018 |
| Revision | A |
| Revision Note | A Kerb foundation altered 10-10-18 |

Construction Details

Section 1 Kerbing

Detail 4 125 x 255mm PC 45° Splay Kerb

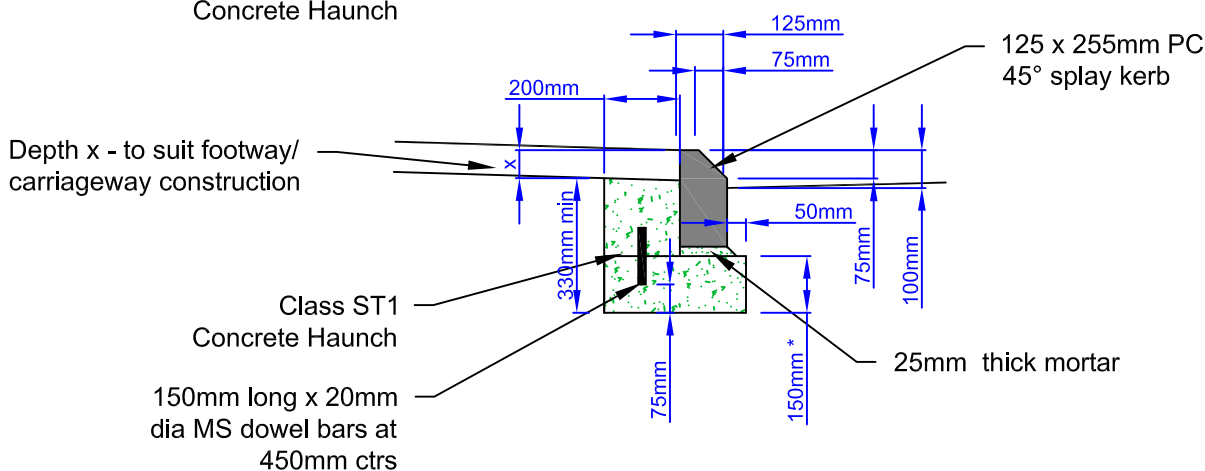
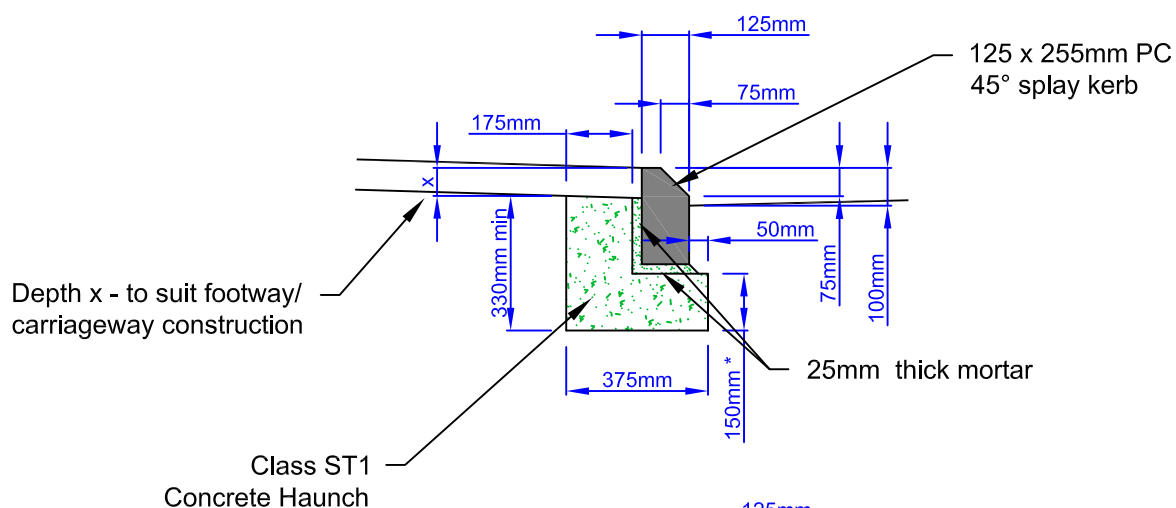

Notes

- SHW refers to the Specification for Highway Works
- All kerbs to BS 7263 Part 1:1990 Half batter kerbs to be used adjacent to footways
- Concrete mix ST1 (SHW Table 26/1: refer BS.5328:Part 2) for bedding and backing to precast concrete kerbs, channels, edgings and quadrants
- All Mortar shall be designation (i) Table 24/1 (SHW)
- Depth of foundation to be 150mm or depth to top of sub base whichever is greater.

125 x 255mm Precast Concrete 45° Splay Kerb Detail

| | |
|---------------|------------------------------------|
| Drawing No. | CD-S1-D4 (125 x 255 Spaly Kerb) |
| Scale | 1:20 |
| Date | 31 August 2018 |
| Revision | A |
| Revision Note | A Kerb foundation altered 10-10-18 |

Visibility Splays

| Visibility Splays for Main Roads | | | | | Visibility Splays for Residential Roads | |
|---|-----|-----|-----|-----|---|----|
| Speed MPH | 30 | 40 | 50 | 60 | 20* | 30 |
| 'Y' Distance in metres | 90 | 120 | 160 | 215 | 20 | 90 |
| 'X' Distance in metres | 2.5 | | | | 2 | |
| *Where the speed limit is 20 MPH or the nature of the road reduces vehicle speeds | | | | | | |

Clear sightlines, from any new access, are essential to enable drivers, exiting the road, to check in both directions for vehicular traffic before safely joining the adjacent public road. That is from a point 'x' metres back from the road edge of the carriageway, there should be an unrestricted view, above a height of 1.05 metres, for a distance of 'y' metres in both directions.

To ensure an adequate and safe inter-visibility between vehicles exiting from a driveway and pedestrians on any adjacent footway or carriageway, a visibility splay of 2 metres back from the edge of the driveway ('x' distance) and 5 metres in either direction from the edge of the driveway ('y' distance) should be provided. No obstructions above a height of 1.05 metres will be accepted in either direction within the aforementioned splay.

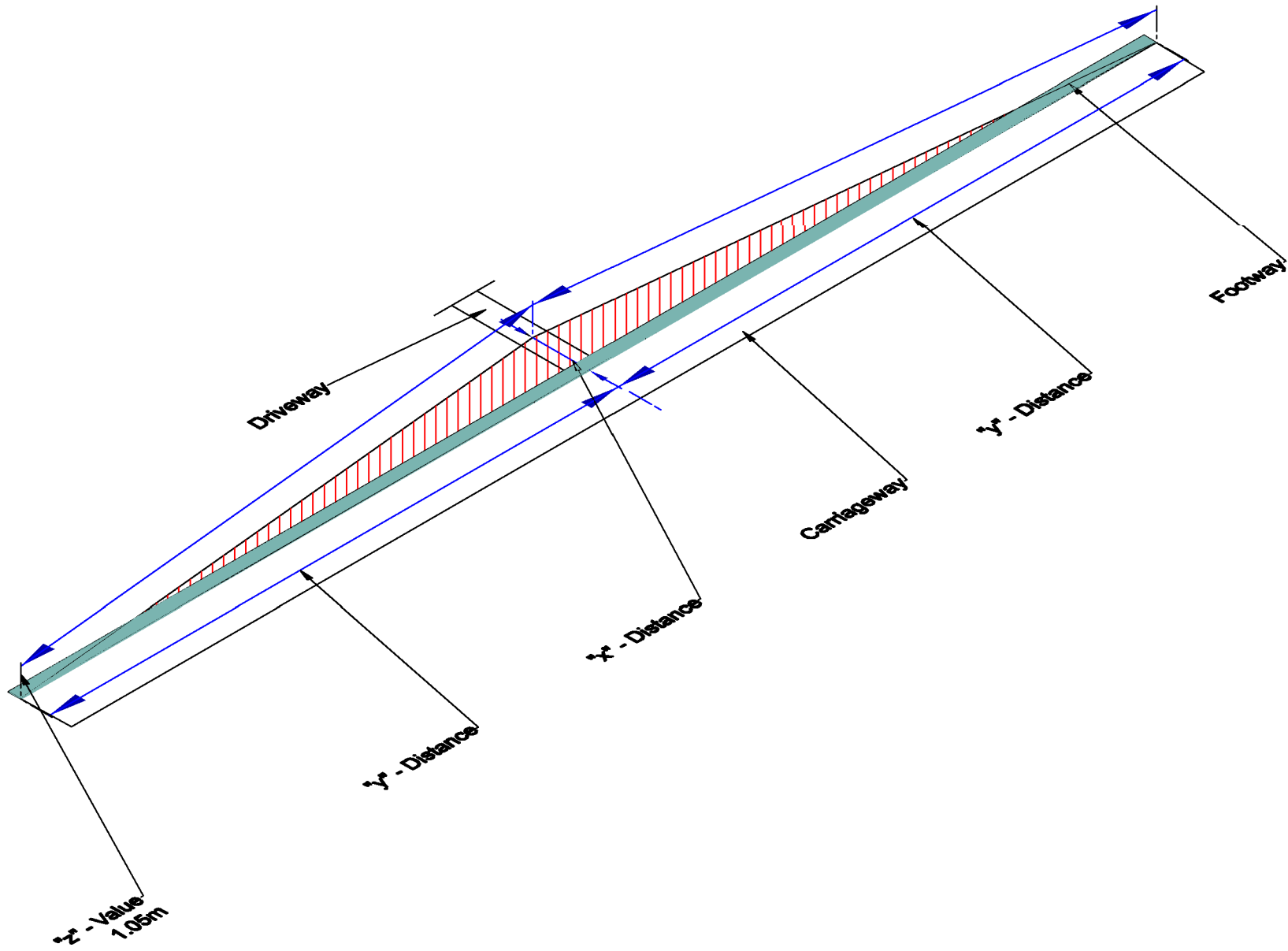

2.0m x 5m x 1.05m driveway/
pedestrian visibility splay
(shown as blue hatch)

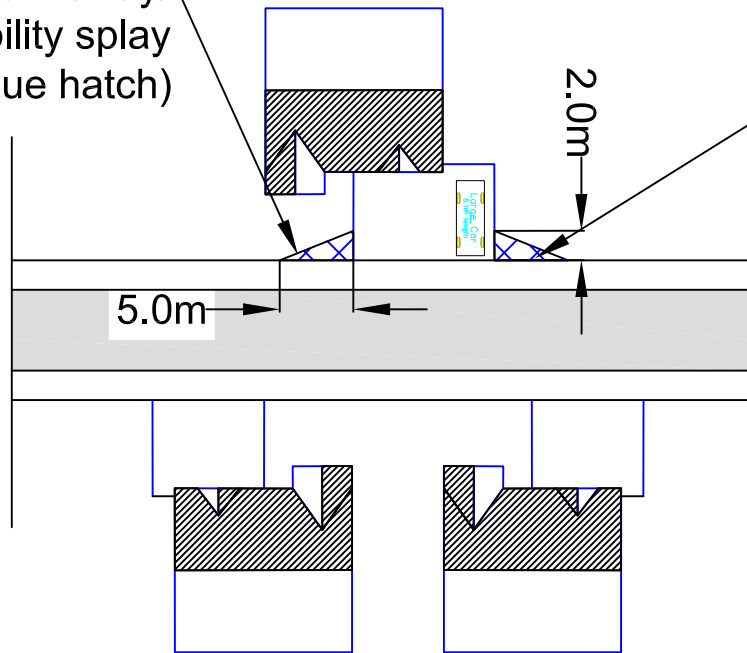

2.0m x 5m x 1.05m driveway/
pedestrian visibility splay (shown as
blue hatch)

Visibility splays should be kept clear
of vegetation, landscaping features,
fencing, buildings etc above 1.05m.

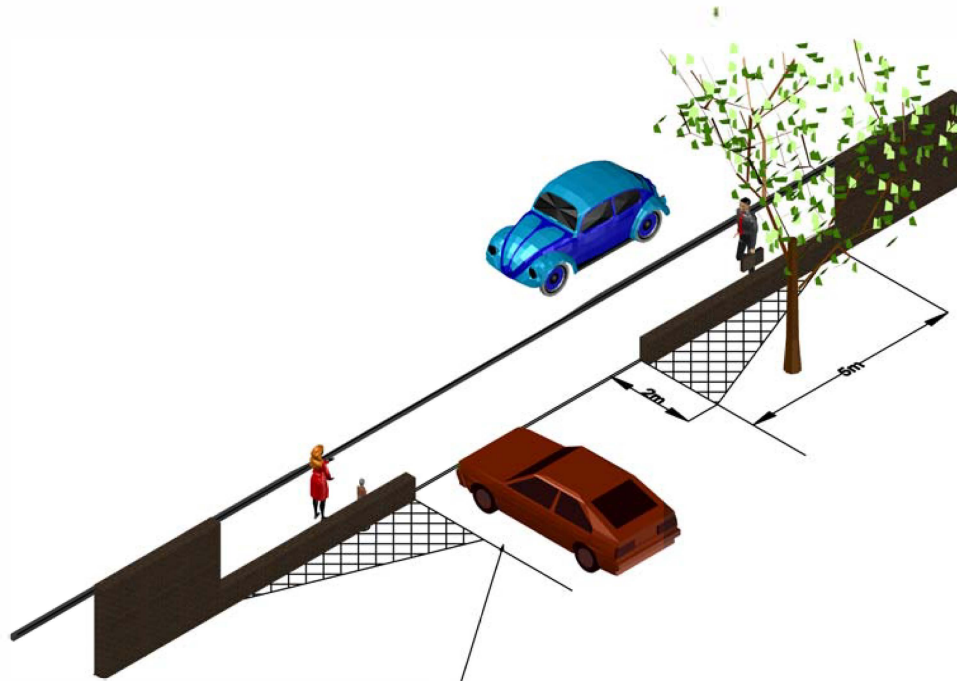

Visibility Splay formed from points between 2m back from heel line and 5m along heel to be kept clear of any walls, hedges, fencing, vegetation, landscaping etc above 1.05m in height. This is to allow drivers to be able to see pedestrians (and vice versa) walking along the adjacent footway.

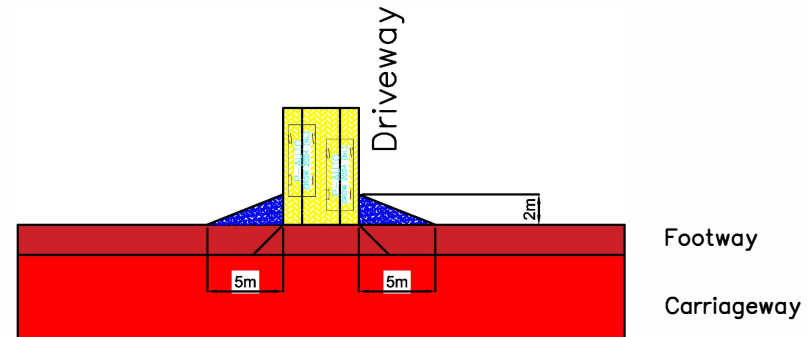

■ Driveway visibility splay (for Pedestrian movements). No vegetation, landscaping features, fencing etc above 1.05m in height will be accepted within this splay.
 (Note: – footway may not be present for shared surface layouts)

Drawing Info.

Reproduced from the Ordnance Survey Mapping with the permission of Her Majesty's Stationary Office (C) Crown Copyright.
 Unauthorised reproduction infringes Crown Copyright and may lead to prosecution or civil proceedings. ERC Licence No. (c) Crown Copyright. 100023382 2015

East Renfrewshire Council - Environment Department
 Environment Service and Roads - 2 Spiersbridge Way, Spiersbridge Business Park,
 Thornliebank, G46 8NG
 Head of Service: Andrew Corry

| | | |
|---|----------|---------------------|
| Drawing Title | | Date |
| (Pedestrian) Visibility Splay at Driveway | | 1/10/15 |
| | | Scale 1:1000 NTS |
| D | N | Dwg By |
| | | Checked By |
| | | |

